

NOTES: UNLESS OTHERWISE SPECIFIED.

1. LABEL PER CUSTOMER SPECIFICATION
2. CONNECTIONS POLARITY :

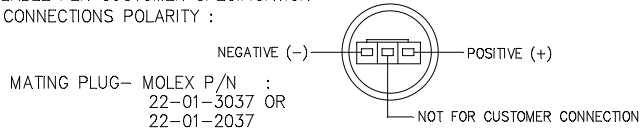

3. TEMPERATURE COMPENSATION ERROR IS $\pm 5\%$ OF FULL SCALE OVER THE OPERATING TEMPERATURE RANGE. (AFTER CALIBRATION AT 25°C) THE WORST CASE TRACKING ERROR (WITHIN THE FIRST HOUR AFTER A MAXIMUM TEMPERATURE STEP) IS $\pm 10\%$ OF FULL SCALE. (GAS SAMPLES MUST BE BROUGHT TO AMBIENT TEMPERATURE) PERCENT READOUT IS ONLY WITHIN $\pm 1\%$ AT CONSTANT PRESSURE (E.G. A 10% INCREASE IN PRESSURE WILL RESULT IN A 10% INCREASE IN READING).
4. ASSEMBLY TO BE PACKAGED IN A GAS BARRIER BAG.
5. ASSEMBLY MANUFACTURED AND TESTED TO MPD61679.

SPECIFICATIONS:

1. OUTPUT - (9-14MV) IN AIR 25°C AT SEA LEVEL.
2. RANGE - 0-100% OXYGEN (MAX), 0-1% OXYGEN (MIN).
3. RESPONSE TIME - LESS THAN 6 SEC. FOR 90% OF FINAL VALUE.
4. OPERATING TEMPERATURE RANGE - 0° TO 40°C (32° TO 104°F)
5. AVG EXPECTED CELL LIFE - 36 MONTHS IN AIR AT 25°C, 50% R.H.
6. STORAGE TEMPERATURE - 0° TO 50°C (32° TO 122°F)
7. HUMIDITY - 0 TO 99% RH (NON-CONDENSING).
8. ACCURACY - WITHIN $\pm 1\%$ OF FULL SCALE AT CONSTANT TEMPERATURE AND PRESSURE (SEE NOTE 3)
9. WEIGHT - 1.2 OZ (32 GM)
10. OFFSET - $< 0.1\%$ O₂ IN < 30 SECONDS FOR A STEP CHANGE FROM AIR TO 0% O₂.
11. REQUIRED LOAD 10K

| REVISIONS | | | | |
|-----------|------------------|----------|------|---------|
| REV | DESCRIPTION | DATE | APP. | REV. BY |
| 7 | INC. ECO 96-0713 | 6-11-97 | MG | JCR |
| 8 | INC. ECO 99-0164 | 11/17/99 | JML | DC |
| 9 | INC ECO 07-0175 | 8/8/08 | MG | VF |

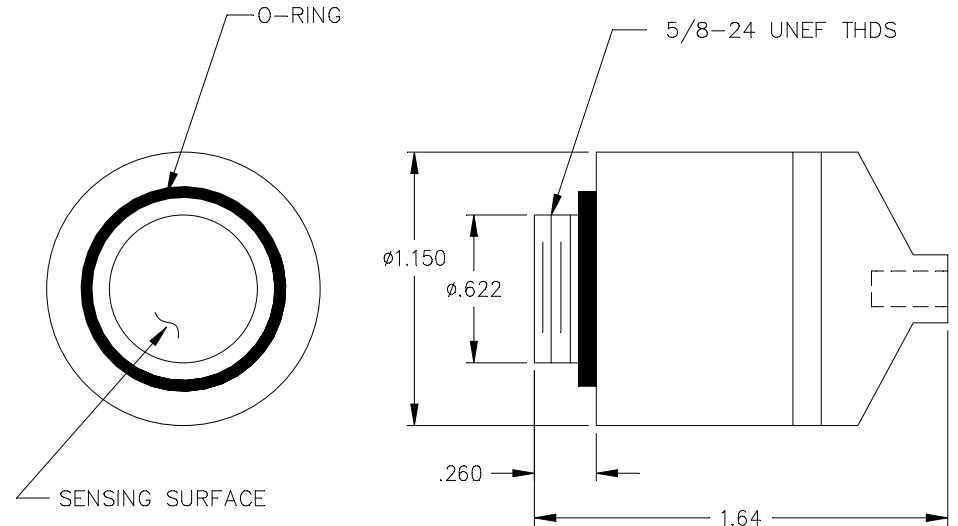

| | | | | |
|--|-------------------|--|---|-----------------|
| DO NOT SCALE DWG | | THIS DRAWING IS THE PROPERTY OF TELEDYNE INSTRUMENTS AND CONTAINS CONFIDENTIAL INFORMATION. IT IS NOT TO BE COPIED, REPRODUCED OR USED WITHOUT WRITTEN PERMISSION. | | |
| TOLERANCE UNLESS OTHERWISE SPECIFIED: ANGULAR $\pm 1/2^\circ$ | | TELEDYNE INSTRUMENTS <i>Analytical Instruments</i> A Teledyne Technologies Company City of Industry, California, 91748, USA | | |
| LINEAR $\begin{cases} .X & = \pm .1 \\ .XX & = \pm .02 \\ .XXX & = \pm .010 \end{cases}$ | | TITLE | | SCALE NONE |
| S/ | SIGNATURES | DATE | SPEC CONTROL DWG OXYGEN SENSOR CLASS R21A | SIM NONE |
| N/ | DRFT: L. GARCES | 04/28/93 | | SHEET 1 OF 1 |
| I/ | CHK: | | | |
| P/ | APPR: | | | |
| O/ | ENGR: JAY LAUER | | | |
| F/ | C.O.: | | MATL. NOTED | DWG NO. B-56358 |
| REFERENCE | CAD I.D. B56358-9 | | | REV 9 |